

PRODUCT DATA SHEET

Movement joint profile PVC
Screed
Item no. 3929

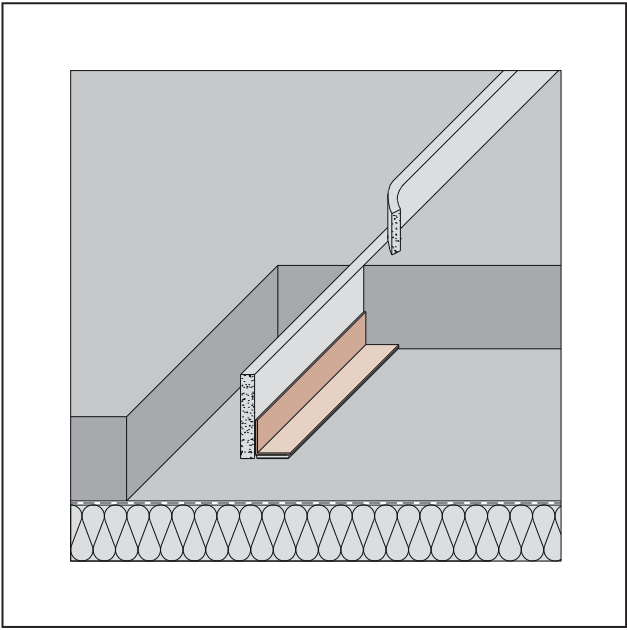

Status: 08.07.2025 | 12:07

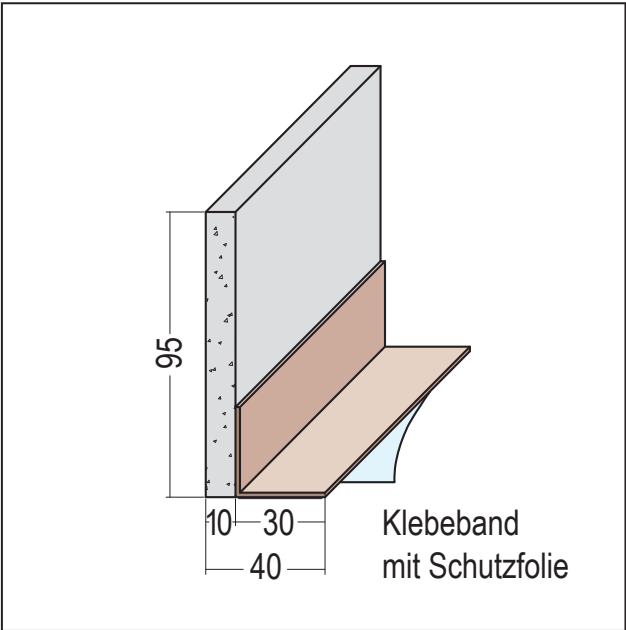

Designation	Movement joint profile PVC Screed
Description	<p>The movement joint profile is characterised by its special asymmetric shape. The 95-mm-high PE strip on the movement joint profile is elastic yet retains its shape relatively well. This allows for the universal application of just a single movement joint profile for various screed heights. This reduces the need for warehousing. Double installation is also possible with the asymmetric movement joint profile, ensuring greater screed movement absorption. The asymmetric shape of the movement joint profile provides for clean and de-coupled connections to other construction elements.</p> <p>Function:</p> <ul style="list-style-type: none">• asymmetric movement joint profile, for simple as well as double installation• clean connections to other construction elements offered by the asymmetric shape• universal applications for various screed heights• secure de-coupling• simple installation
Product area	Concrete / screed
Product category	Joint profiles
Material	Hard PVC + PE strips
Product length	250,000 cm
Product width	40 mm
Product height in mm	95 mm
Packaging Unit	12 PCS / 12 BOX
Processing instructions	<p>The movement joint profile is characterised by its asymmetric shape. The 95-mm-high PE strip is elastic yet retains its shape relatively well. This allows for the universal application of just a single movement joint profile for various screed heights. This reduces the need for warehousing. Double installation is also possible with the asymmetric movement joint profile, ensuring greater screed movement absorption. The asymmetric shape provides for clean and decoupled connections to other construction elements.</p>

This product data sheet corresponds to the current state of development of our products and loses its validity upon publication of a new edition. Make sure you are using the latest edition of this information. Warranty and liability are based on delivery according to our general Terms and conditions. Please observe the application assembly and storage guidelines.

PRODUCT DATA SHEET

Movement joint profile PVC

Screed

Item no. 3929



All statements without guarantee. Reserve technical changes. Product illustrations may differ from the delivery product. Tender specifications, installation instructions and performance declarations (if required by law) can be found on our homepage. Please respect the environment for a proper disposal!