

# PRODUCT DATA SHEET

Metal sheet connecting profile for exterior render

18 mm

Item no. 2765



Status: 12.04.2024 | 12:04

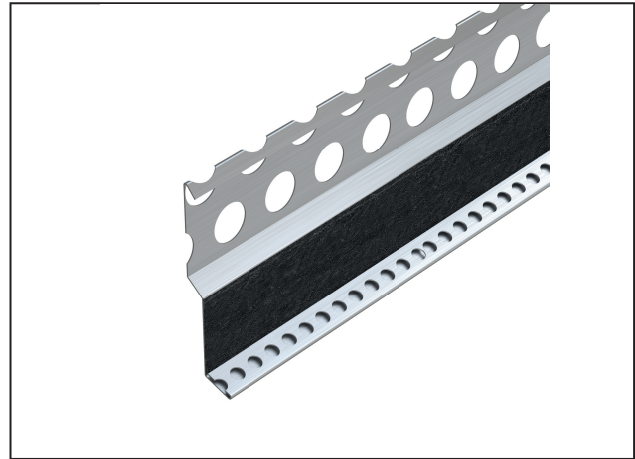
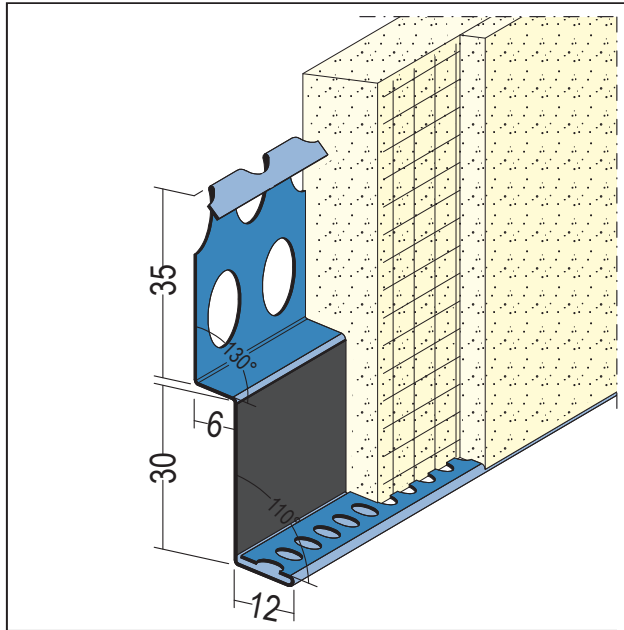

<b>Designation</b>	Metal sheet connecting profile for exterior render 18 mm
<b>Description</b>	PROTEKTOR Plasterable metal connection profile made of stainless steel for exterior plaster of 18 mm and thicker. For creating clean connections, such as for sheet metal flashings on roofs.
<b>Product area</b>	External rendering
<b>Product category</b>	Connecting profiles
<b>Types of mortar</b>	Silicate plaster, Reinforcing plaster organ, Insulating plaster, Deposits cleaning, Gypsum mortars and mortars containing gypsum, Gypsum plaster, Lime plaster, Lime cement plaster, Clay plaster, Restoration plaster
<b>Plaster thickness</b>	18 mm
<b>Material</b>	Stainless steel
<b>Product length</b>	250 cm
<b>Angular Position</b>	110°
<b>Reaction to fire (R2F)</b>	E
<b>Treatment</b>	The sealing in the area of the joints to the profile extension or at inner and / or outer corners must be carried out on site using suitable sealing material below the profile joints.
<b>Packaging Unit</b>	10 PCS / 49 BUN
<b>Annotation</b>	An additional reinforced plaster layer on the base render is recommended to increase the stability of the plaster layer.

This product data sheet corresponds to the current state of development of our products and loses its validity upon publication of a new edition. Make sure you are using the latest edition of this information. Warranty and liability are based on delivery according to our general Terms and conditions. Please observe the application assembly and storage guidelines.

All statements without guarantee. Reserve technical changes. Product illustrations may differ from the delivery product. Tender specifications, installation instructions and performance declarations (if required by law) can be found on our homepage. Please respect the environment for a proper disposal!